

## Product Data Sheet

Product Name: SecureBox TS-7

Manufacturer: i-Checkin GmbH

Address: Fichtenweg 8, Bad Harzburg, Germany

Website: <https://i-checkin.net/>

Contact: +49 5322 9504733, [info@i-checkin.net](mailto:info@i-checkin.net)

### Product Overview:

SecureBox TS-7 is a universal electronic door lock controller designed specifically for guest access systems in vacation rentals. It integrates seamlessly with channel managers and booking platforms, providing an efficient, secure, and user-friendly check-in experience.

### Purpose:

SecureBox TS-7 is engineered to optimize the check-in process for temporary accommodation units, offering instant door control and enhancing the guest experience in tourist-frequented lodgings.

### System Architecture:

The device comprises two main components: a user interface and a backend server. The user interface includes both hardware and software elements, facilitating easy interaction and management.

### Hardware Specifications:

- Microcomputer: ARM CPU based
- Control: Relay dry contacts (2 x NC/NO), 8A~250V
- Connectivity for Electronic Locks: Z-Wave
- Power Supply: ~100-240V, 50/60Hz certified unit
- Dimensions (L x W x H): 208 x 115 x 40 mm
- Weight: 495 g

### Software & Connectivity:

- Operating System: Linux-based
- Access: Wi-Fi, Ethernet (IPv4)
- Display Capabilities: Information display on microcomputer screen and smartphone

### Security Features:

- Data Protection: AES-256 encryption
- Communication: Secured tunneling

### Technical Specifications:

- Touch Screen: 7 inches
- Power Supply Unit: 5.1V 3A

### Installation Guidelines:

Connect the normally open contacts (NO + COM) of the device's relay in parallel with the normally open contacts of the intercom relay.

For the normally closed contacts (NC + COM) of the device's relay, connect them in a manner that interrupts the circuit managed by the normally closed contacts of the intercom relay.

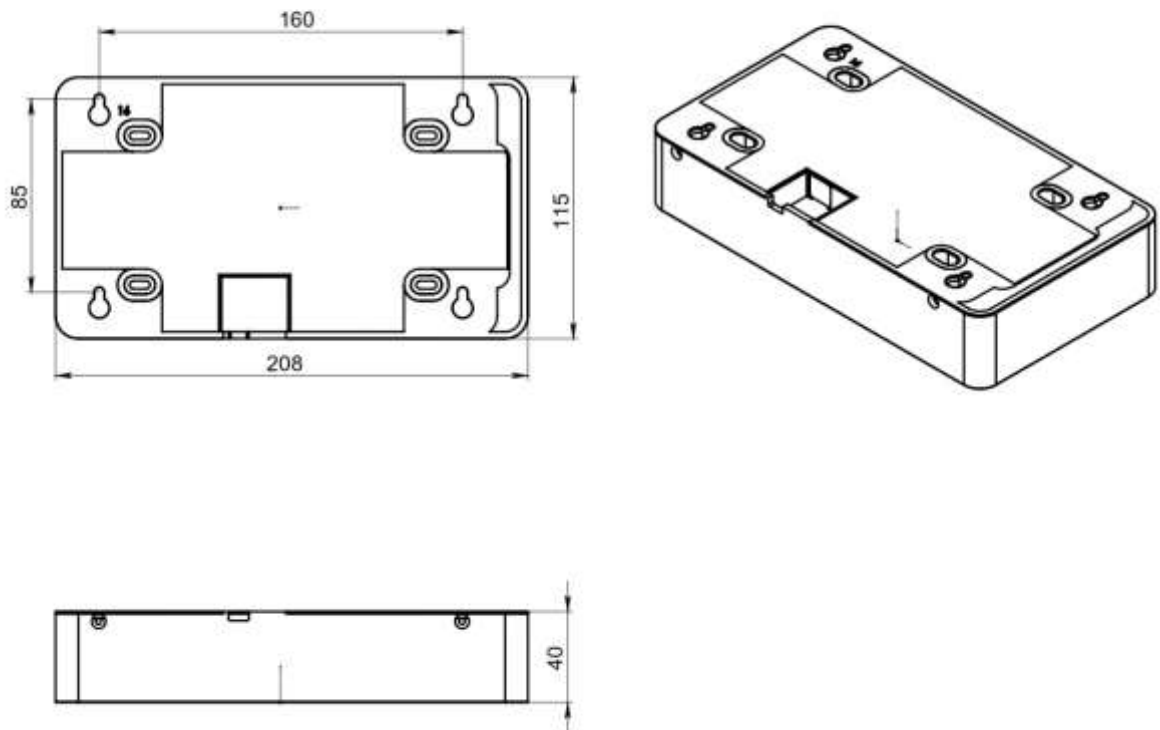

**Caution:** For power circuits, consult the manufacturer if load exceeds specifications or protection against self-induction is uncertain.

**Note:**

This device is tailored for control circuits and NOT for power circuits. If the intercom needs to be connected, the manufacturer highly recommends that the device be installed by certified technicians only. Specifications and features are subject to change without notice.

**Legal Notice:**

Copyright © i-Checkin GmbH. All rights reserved. Information is subject to change.